

# ASSEMBLY INSTRUCTIONS

## MAXIM HOME THEATRE LOUNGE



### Maxim Home Theatre Lounge Range

① The components are heavy, assembly should be performed by two people.

If you have any difficulty with assembly or operation, please contact the store of purchase in the first instance.

Please read the below safety & electrical instructions before operating

#### Safety Instructions

- This product is not intended for use by persons (including children) with reduced physical, sensory or mental capabilities, or lack of experience and knowledge, unless they have been given supervision or instruction concerning use of the product by a person responsible for their safety.
- Ensure there is no person, animal or item obstructing the area under the footrest before operating this product.
- Improper use or installation may result in the risk of fire, electric shock and/or injury. We assume no liability for any eventual damages caused by improper use or inappropriate handling, or by any other non-compliance with the instructions in this manual.
- Children should be supervised to ensure that they do not play with the product.
- This product contains moving parts. Keep fingers, hair and body parts well clear from moving parts. To reduce the risk of injury, keep children and pets clear of the product when in use.
- Do not sit or place additional weight on the arms, back or open footrest.
- This product is very heavy. Only move this product by lifting the main body. Never drag by the footrest, back or arm rest.
- Return this product to the full upright position to stand safely and prevent a tripping hazard.
- Do not operate this product if damage is visible in any form.
- Do not modify or use unauthorised substitute parts.
- This product has been designed and intended for indoor residential use only. It is not suitable for commercial or outdoor use.
- This product is not intended to be used as part of a health care plan. Consult your medical professional before operating if you are taking medication or have physical limitations.

#### Electrical Instructions

- Never force the back or footrest to close faster than the electric motor.
- Before commencing cleaning or maintenance, ensure this product is disconnected from the power outlet and the back is in the full upright position.
- Disconnect this product from the power outlet before moving.
- Cease operation and disconnect from the power outlet if you ever detect a burning odour or smoke coming from the product.
- Do not operate this product if liquid spillage occurs on or around it. Disconnect from the power outlet and allow product to completely dry before reconnecting.
- Do not operate the power functions or charge station with wet hands.
- Check the condition of the power cord, electrical cords, transformer, plug and connector on a monthly basis. Do not operate if wear is visible.
- Ensure the power cord, electrical cords and transformer are clear of moving parts and not trapped underneath the base.
- Position the power cord to minimise a tripping hazard.
- Never attempt to open or disassemble electrical components.
- We recommend the use of a surge protector (not included).
- Connect power supplies directly to a wall outlet wherever possible. If a powerboard is required, check its maximum power load and don't exceed. Never "daisy-chain" more than one powerboard together.

Synargy is a registered responsible supplier on ERAC. Electrical components within our products have been tested to comply with legal requirements imposed for electrical safety and EMC.

## 4 Seater / 3 Seater / 2 Seater Assembly

### Step 1

Take note of the seat labelling on the packaging before removing and dismissing packaging. Underneath each of the two consoles is a zippered pocket with 4 screw-in feet. Install these to the consoles before proceeding to Step 2.

### Step 2

Arrange the seat bases and consoles according to the below diagram, using the labelling from Step 1 to identify each piece.

Connect using the brackets down the side of each piece. Note that there is a left-hand side specific Console and Armless Chair and a right-hand side specific Console and Armless chair.

If the brackets don't align or the electrical connections don't easily reach (Step 5) check that you have the correct piece in the correct location.

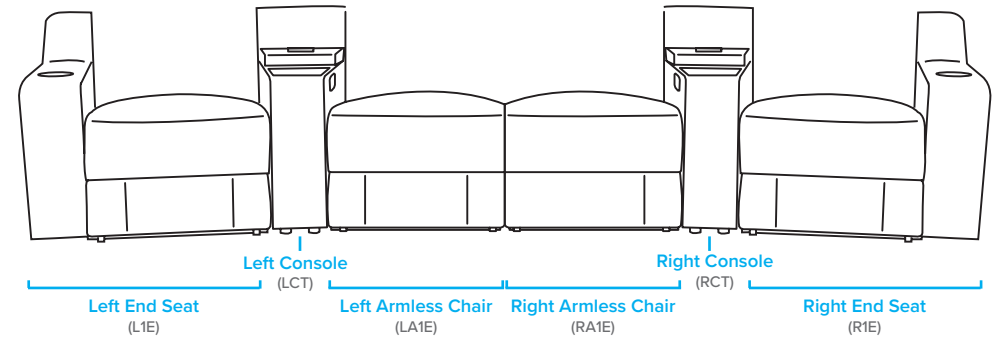

### Step 3

Attach the seat backs to the seat bases according to below diagram:

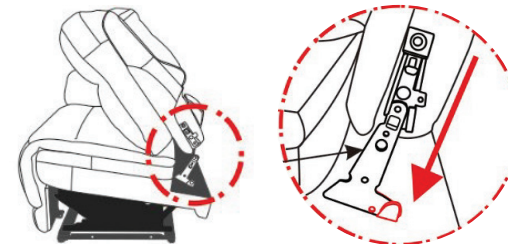

Scan QR code  
for a video of  
this step

# ASSEMBLY INSTRUCTIONS

## MAXIM HOME THEATRE LOUNGE

### Step 4

Connect the electric cables A & B together in 4 locations. These connect the seat back to the seat base to supply power for the electric headrest.

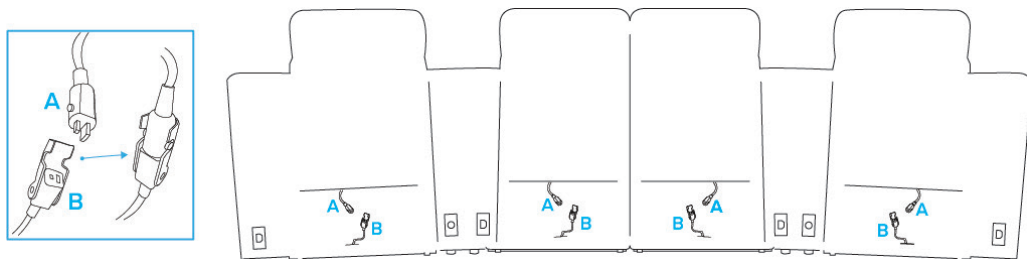

### Step 5

Connect the electric cables C to D, E to F, and G to H in 2 locations - between the armless chair and the corresponding console table. This supplies power to the armless chairs for electric recline, headrest and heated seat - via the console table's wall outlet power supply.

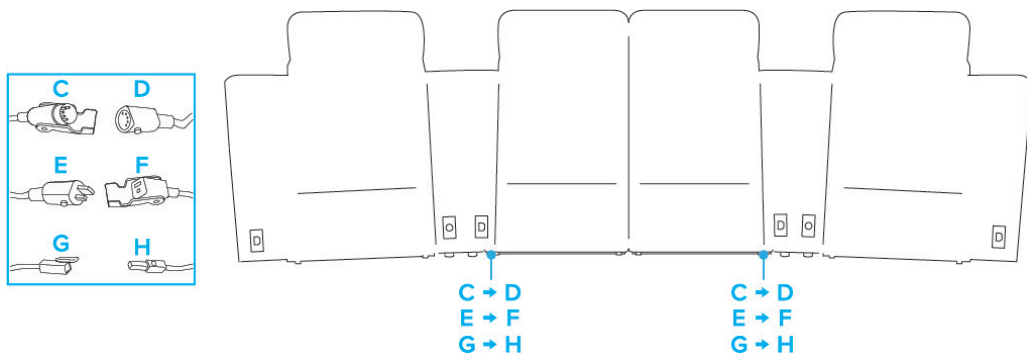

### Step 6

Connect the power supplies to the lounge suite.

The four cables with power boxes are for powering the electric recline, headrest and seat heating features. The two cables without power boxes are separate power supplies for the wireless chargers in the console tables.

Connect directly to a wall outlet wherever possible. If a powerboard is required, check it's sufficiently rated.

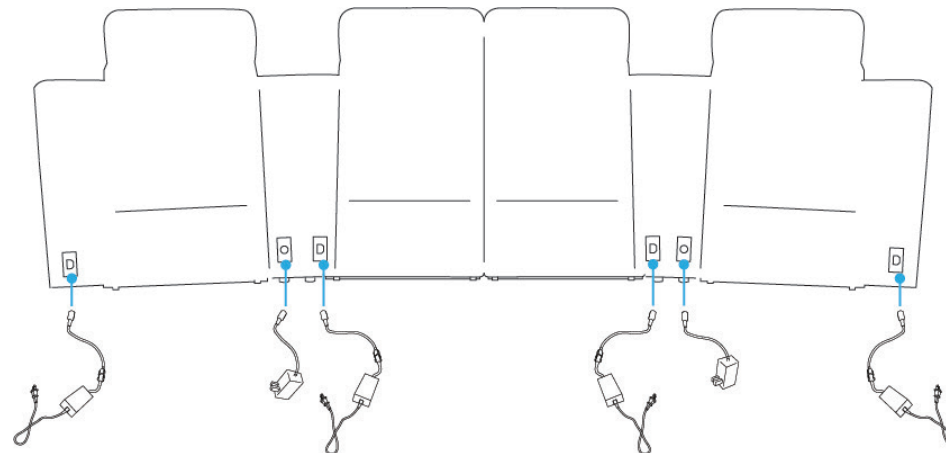

ⓘ NOTE: The heat function automatically switches off after 20 minutes.

# ASSEMBLY INSTRUCTIONS

## MAXIM HOME THEATRE LOUNGE



### Maxim Home Theatre Lounge Range

ⓘ The components are heavy, assembly should be performed by two people.

If you have any difficulty with assembly or operation, please contact the store of purchase in the first instance.

Please read the below safety & electrical instructions before operating

#### Safety Instructions

- This product is not intended for use by persons (including children) with reduced physical, sensory or mental capabilities, or lack of experience and knowledge, unless they have been given supervision or instruction concerning use of the product by a person responsible for their safety.
- Ensure there is no person, animal or item obstructing the area under the footrest before operating this product.
- Improper use or installation may result in the risk of fire, electric shock and/or injury. We assume no liability for any eventual damages caused by improper use or inappropriate handling, or by any other non-compliance with the instructions in this manual.
- Children should be supervised to ensure that they do not play with the product.
- This product contains moving parts. Keep fingers, hair and body parts well clear from moving parts. To reduce the risk of injury, keep children and pets clear of the product when in use.
- Do not sit or place additional weight on the arms, back or open footrest.
- This product is very heavy. Only move this product by lifting the main body. Never drag by the footrest, back or arm rest.
- Return this product to the full upright position to stand safely and prevent a tripping hazard.
- Do not operate this product if damage is visible in any form.
- Do not modify or use unauthorised substitute parts.
- This product has been designed and intended for indoor residential use only. It is not suitable for commercial or outdoor use.
- This product is not intended to be used as part of a health care plan. Consult your medical professional before operating if you are taking medication or have physical limitations.

#### Electrical Instructions

- Never force the back or footrest to close faster than the electric motor.
- Before commencing cleaning or maintenance, ensure this product is disconnected from the power outlet and the back is in the full upright position.
- Disconnect this product from the power outlet before moving.
- Cease operation and disconnect from the power outlet if you ever detect a burning odour or smoke coming from the product.
- Do not operate this product if liquid spillage occurs on or around it. Disconnect from the power outlet and allow product to completely dry before reconnecting.
- Do not operate the power functions or charge station with wet hands.
- Check the condition of the power cord, electrical cords, transformer, plug and connector on a monthly basis. Do not operate if wear is visible.
- Ensure the power cord, electrical cords and transformer are clear of moving parts and not trapped underneath the base.
- Position the power cord to minimise a tripping hazard.
- Never attempt to open or disassemble electrical components.
- We recommend the use of a surge protector (not included).
- Connect power supplies directly to a wall outlet wherever possible. If a powerboard is required, check its maximum power load and don't exceed. Never "daisy-chain" more than one powerboard together.

Synargy is a registered responsible supplier on ERAC. Electrical components within our products have been tested to comply with legal requirements imposed for electrical safety and EMC.

## Recliner Chair Assembly

### Step 1

Remove the power supply cables from the zippered pocket on the underside of the seat base

### Step 2

Lift the back rest to align the metal receivers with the metal posts of the chair base.

Allow the posts to slide into the receivers (Figure 1), and press down firmly on the top of the backrest until a click is heard on each side

Scan QR code for a video of Step 2

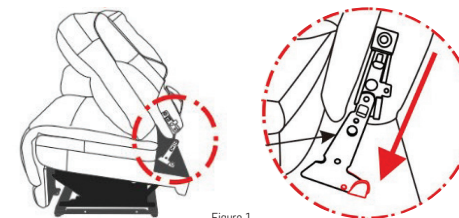

Figure 1

### Step 3

Connect the seat base and seat back cables together (Figure 2)

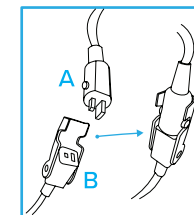
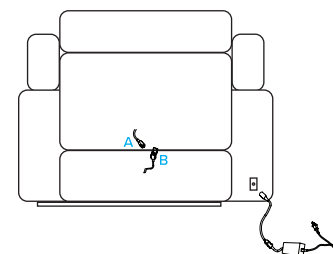

Figure 2

### Step 4

Plug the power supply into the bottom corner of the back of the chair, and plug into wall outlet. Connect directly to a wall outlet wherever possible. If a powerboard is required, check that it is sufficiently rated.



ⓘ NOTE: The heat function automatically switches off after 20 minutes.

